

חברת הפעלה

מתקן תלייה למקר צמוד תקרה

דגם: PJ-020

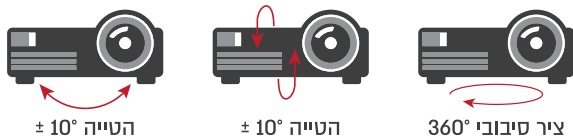

משקל נשיאה



סט ברגים כלול



להנות מסאונד טכנולוגיה וחדשנות

ייבוא ושיווק סירוס אלקטרוניקה בע"מ
רח' אגוד 4, פארק תעשיות חבל מודיעין,
70. www.sel.co.il 03-7355000

WARNING STATEMENTS

Warning

The ceiling structure must be able to load at least equal to the maximum weight 10 kilograms (22lbs). If not, the ceiling must be reinforced. The correct installation procedure by a qualified service technician, according to installation instructions, must persist. Failure to do so may result in serious injury or death, and even death.

Safety measures must be practiced at all times during the installation of this product. Use proper safety gear and tools for the installation procedure to prevent personal injury.

Prior to the installation of this product, the installation instructions should be read and completely understood. The installation instructions must be read to prevent personal injury and property damage. Keep these installation instructions in an easily accessible location for future reference.



A secure structure must support the weight or load of the display. When mounting to a wall that contains wooden studs, dead center of the wooden stud must be confirmed prior to installation.



Do not install on a structure that is prone to vibration, movement or chance of impact. Failure to do so could result in damage to the display and/or damage to the mounting surface.



Do not install near heater, fireplace, direct sunlight, air conditioning or any other source of direct heat energy. Failure to do so may result in damage to the display and could increase the risk of fire.



At least two qualified people should perform the installation procedure. Injury and/or damage can result from dropping or mishandling the display.



Recommended mounting surfaces: wooden studs and solid-flat concrete. If the mount is to be installed on any surface other than wooden studs, use suitable hardware (which is commercially available).

TOOLS REQUIRED NOT INCLUDED

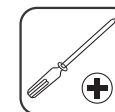

PARTS INCLUDED

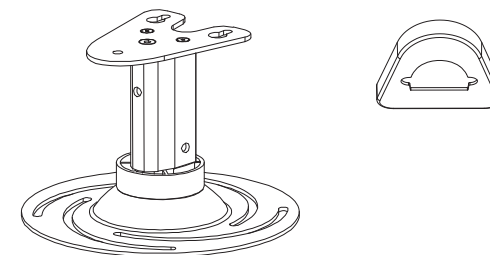

A	M4x16 (x4)	M4x40 (x4)
B	M6x16 (x4)	M6x40 (x4)
C	M6x50 (x3)	Φ 8x40 (x3)
D	Φ 5 (x4)	Φ 15x5.3x1.2(x4)
	M5x12 (x4)	
E	S=4mm (x1)	M6x15 (x2)
F		Arm(x4)

▶ INSTALLATION

①

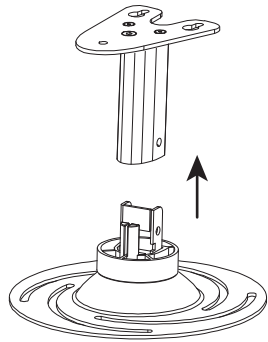

②

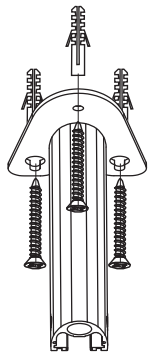
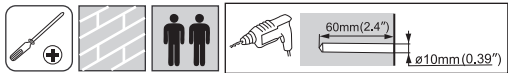
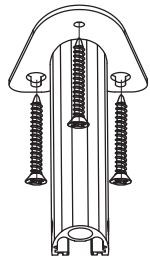
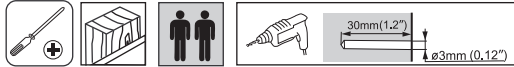

③

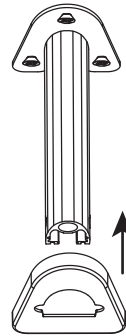

④

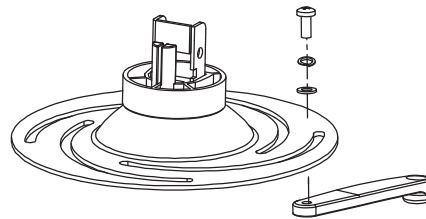

⑤

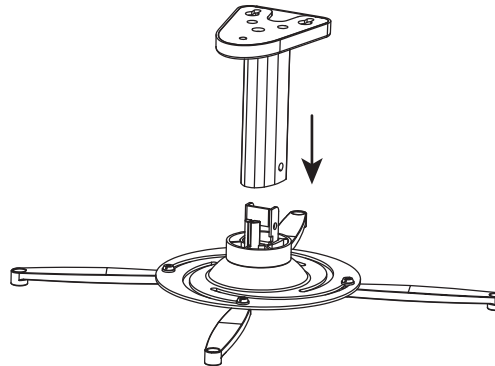

⑥

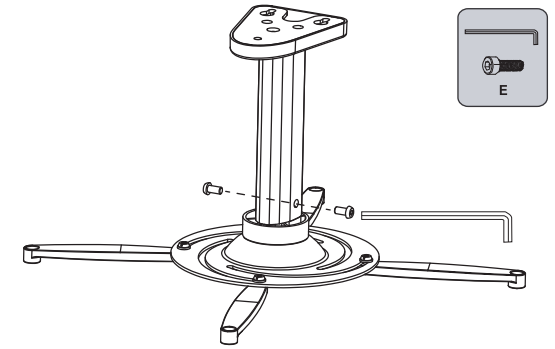

⑦

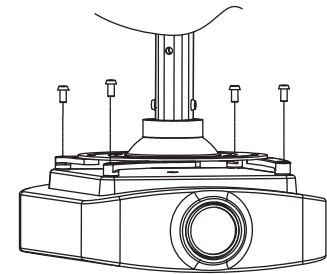
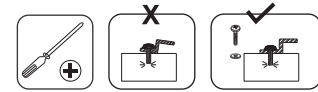

⑧

