

## HG8960 - QUICK INSTALLATION GUIDE

### A. PRODUCT PRESENTATION

#### FEATURES:

- stereo gaming headset with excellent audio quality
- 50 mm speaker size for powerful bass sounds and clear treble
- rotatable microphone arm and in-line remote control
- console & mobile ready
- soft-cushioned synthetic leather ear cups

#### TECHNICAL SPECIFICATIONS

Sound: stereo

Frequency response: 20 Hz - 20 KHz

Speaker size: 50 mm

Speaker sensitivity: 106 dB  $\pm$  3 dB

Speaker impedance: 32  $\Omega$

Microphone type: omnidirectional

Microphone size: 6x2.7 mm

Microphone sensitivity: -42 dB  $\pm$  3 dB

Backlight: blue LED

Connectors: 1x 4-pin 3.5 mm jack, 2x 3.5 mm jack via included splitter, USB (for LED light)

Cable length: 2.2 m

Compatibility: PC, consoles (PS4, Xbox One), mobile

#### SYSTEM REQUIREMENTS

PC system or compatible with the installed sound card, one USB port available.

### B. SAFETY NOTES

- To prevent possible hearing problems, do not use the headphones at high volume for long periods of time.
- Keep the equipment dry. Keep away from precipitation, humidity, all types of liquids and condensation.
- Do not use the product with wet hands.
- Do not use or store the equipment in dusty or dirty areas.
- Do not store the equipment under high-temperature or low-temperature conditions (this may damage it).
- Do not drop, knock or shake the equipment (use may result in breakage).

### C. INSTALLATION

#### C.1 PC system

Connect the provided 3.5 mm splitter cable to the headphone. Each audio jack is colored different (green for headphones, pink for microphone) or has an icon on it. Connect each

jack to the matching input on the sound card. Insert the USB connector into a USB port on

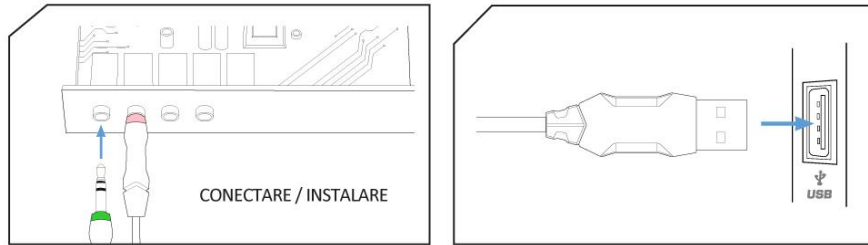

your computer.

*NOTE: This headset does not have a specialized driver and does not require one for proper operation and functionality.*

### C.2 Console/mobile

Connect the 4-pin 3.5 mm jack of the headset to your device.

## D. USE

Use the remote control buttons to adjust the volume, enable / disable the microphone and lighting. The microphone is mounted on a rotatable arm that allows adjustment of its position.

## E. TROUBLESHOOTING

In case of incorrect operation follow the steps below:

- Check the integrity of the connectors;
- Check the connection to the device;
- Check your device settings;
- Disconnect and reconnect the equipment; restart the device.

If the problem persists, please contact your local seller.

## F. GENERAL INFORMATION

- Unauthorized repairs or disassembly of the product will void the warranty and may cause its damage.
- This product is safe and complies to EU requirements.
- This product is manufactured conforming with the European RoHS standard. This standard was introduced to reduce the amount of electrical and electronic waste emitted into the atmosphere.
- Using the WEEE symbol (the crossed-out bin) indicates that this product is not household waste. When recycling waste properly, you protect the environment and people health. Segregated household waste collection, aids recycle materials and components used for the production of this device. For detailed information about recycling, please contact your retailer or a local authority.